

Homezone Streetscape - sc. 1:200

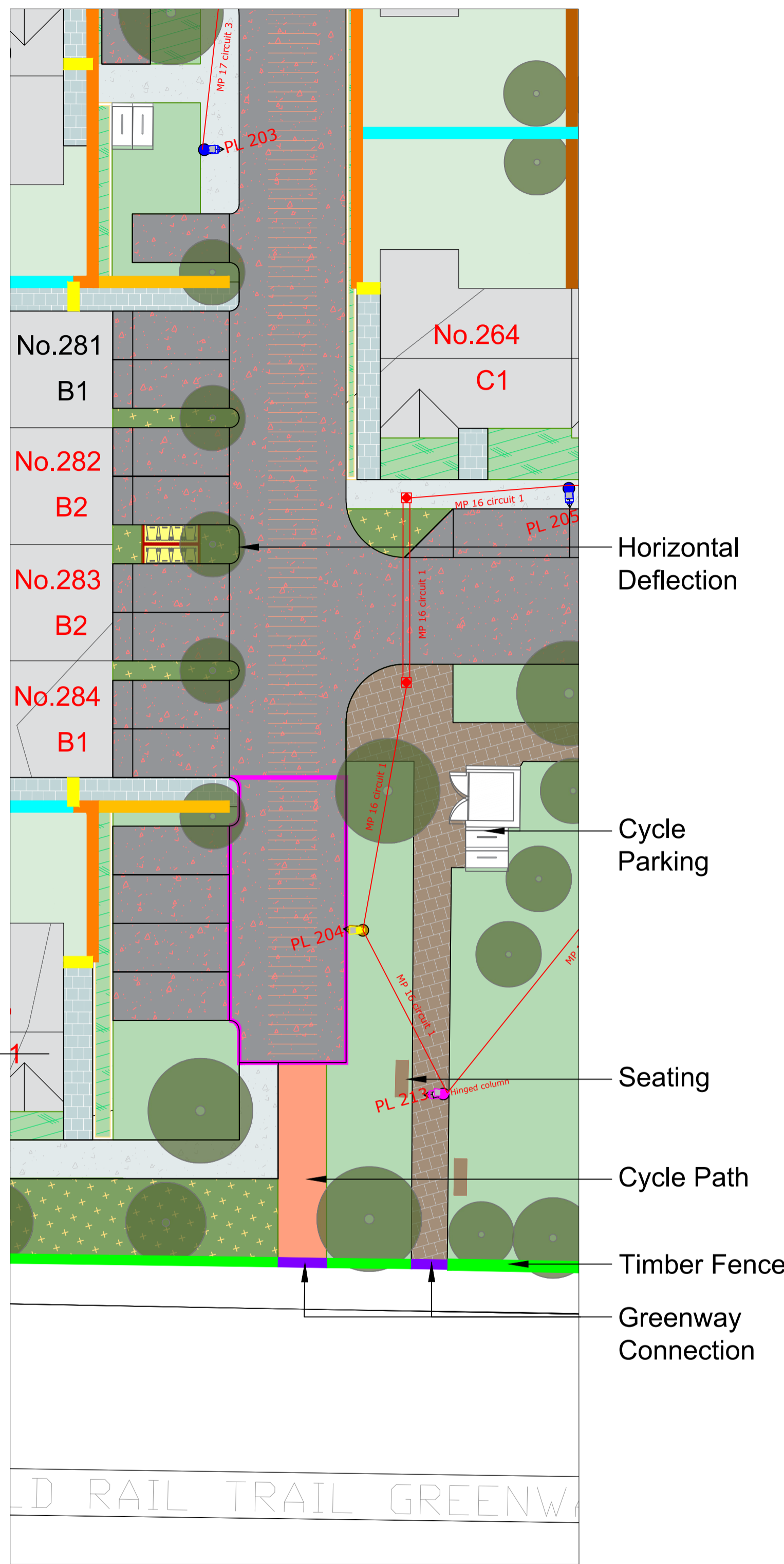

Homezone Streetscape - sc. 1:200

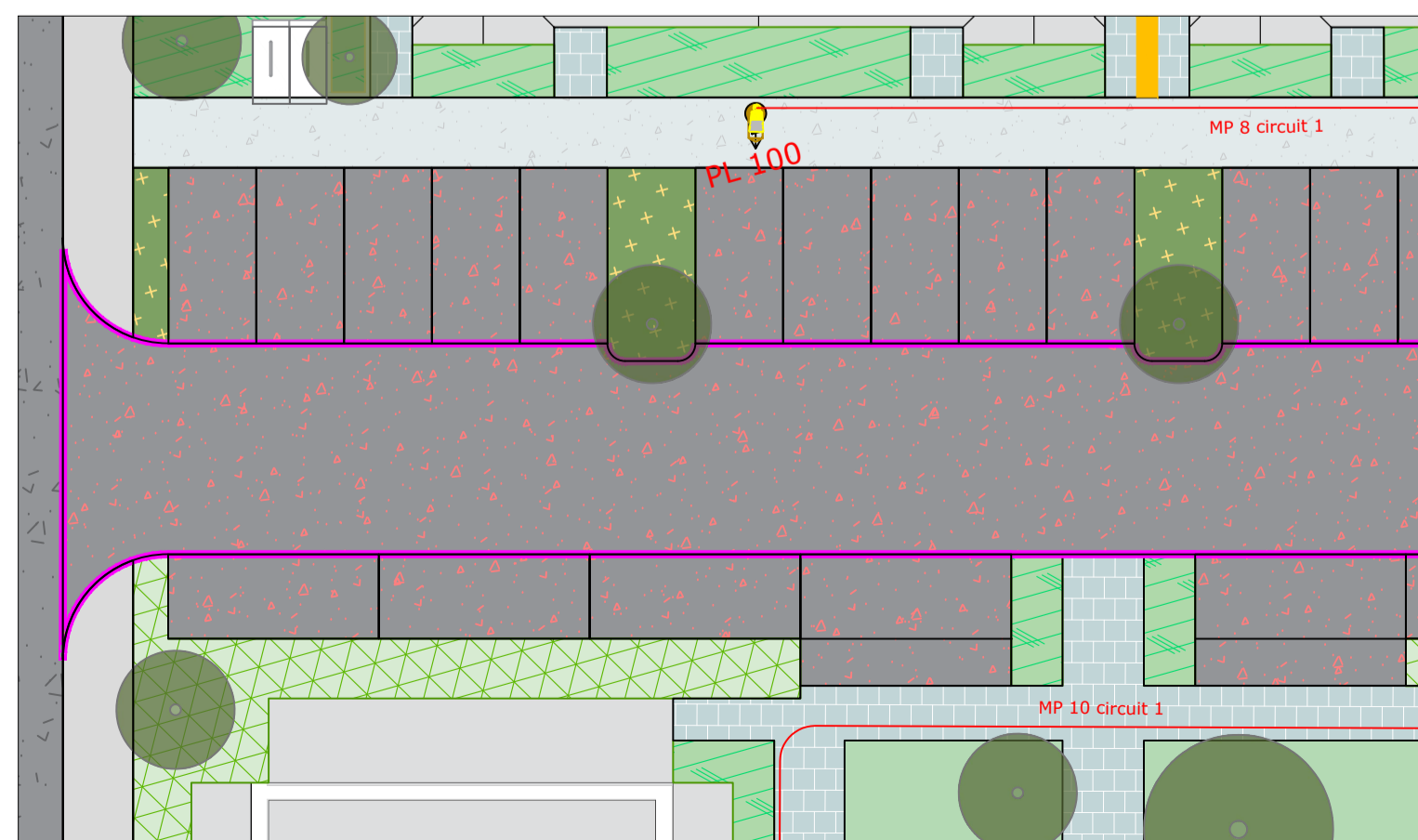

Homezone Streetscape - sc. 1:200

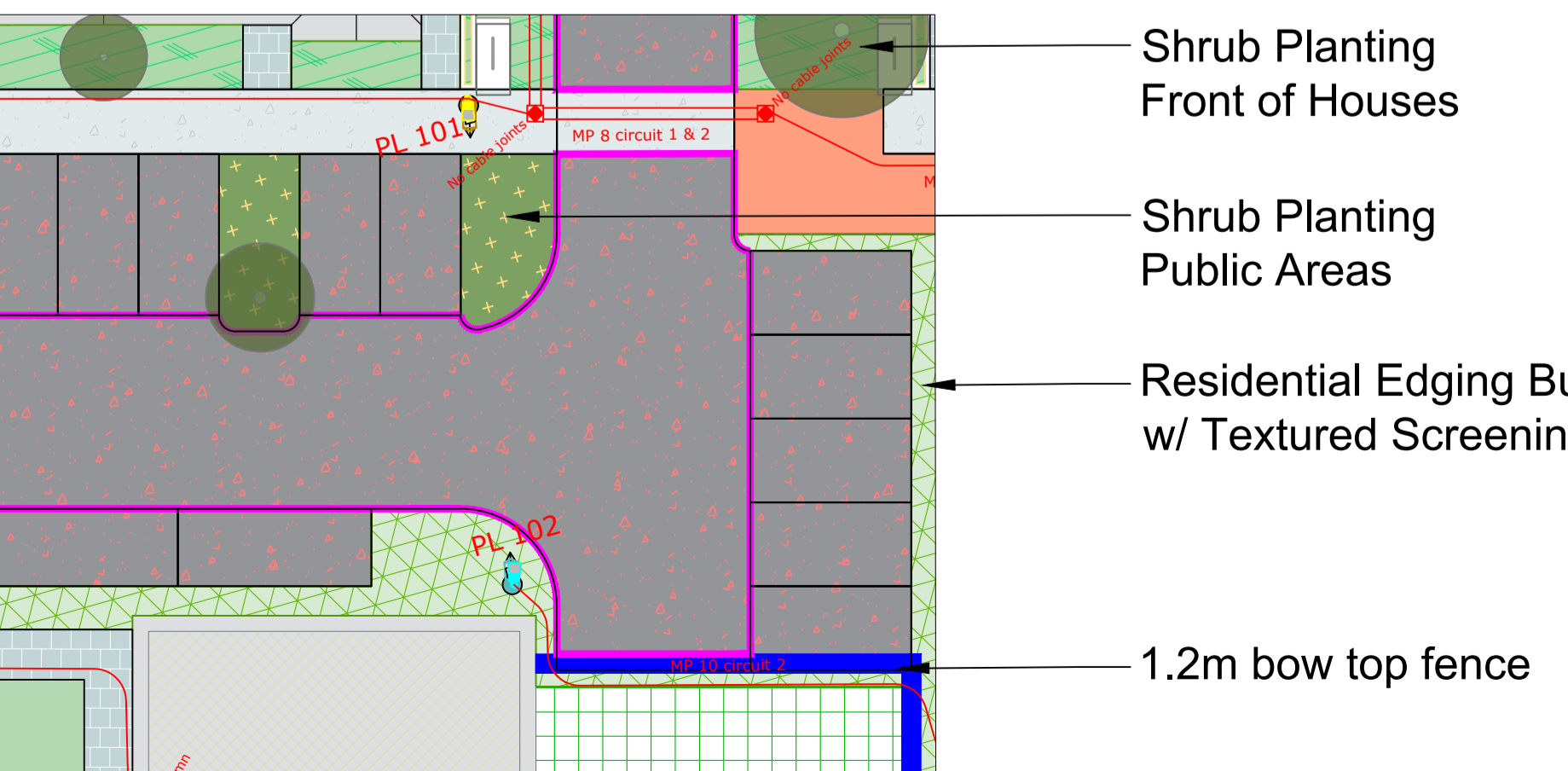
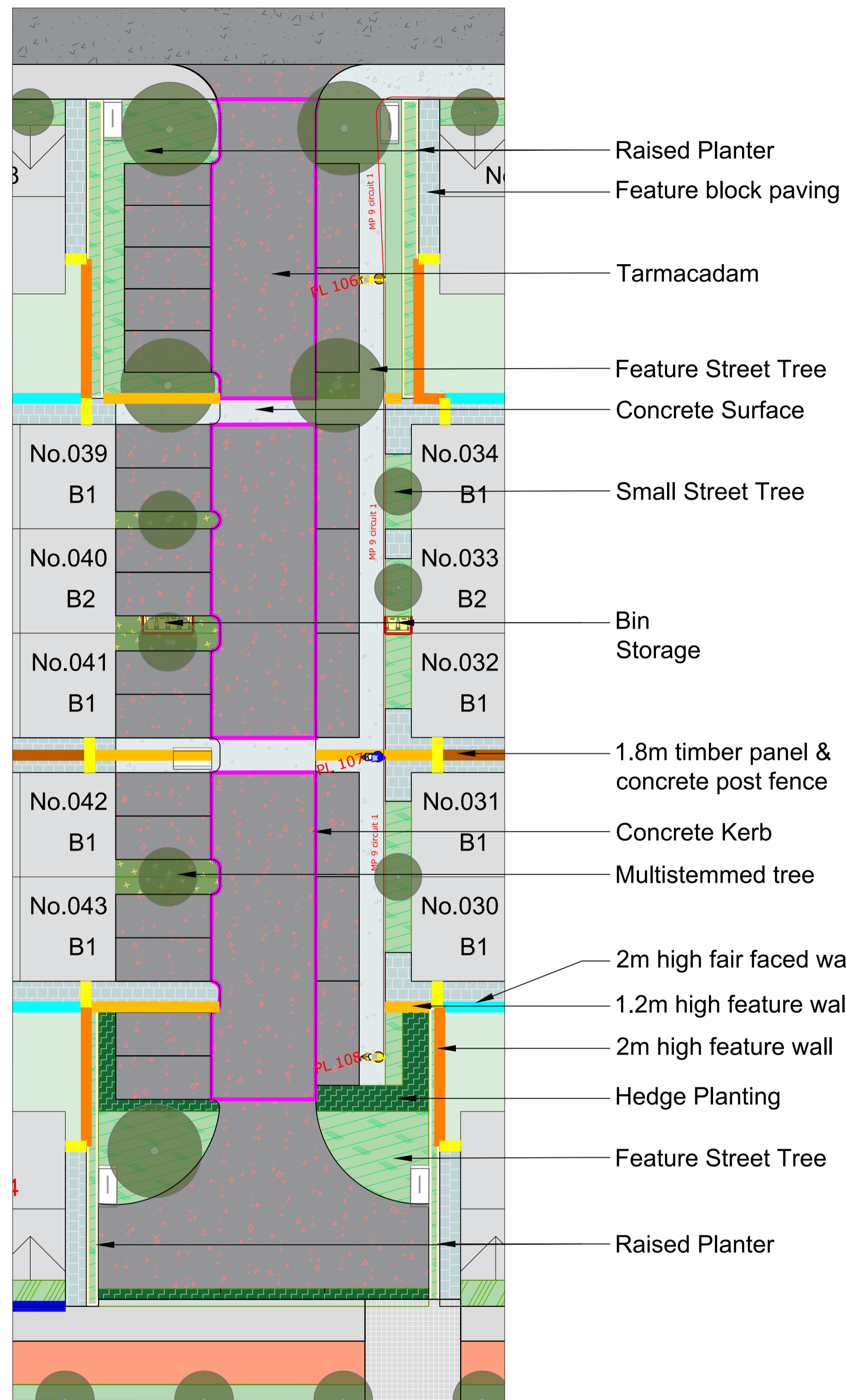

Detail Location Plan - sc. 1:5000



Proposed Tree Planting - 1509 No. Total

Residential Street Trees

Common Name	Species Name	Specification
Common alder	<i>Alnus glutinosa</i> *	r/b 18-20cm gt.
Serviceberry	<i>Amelanchier lamarkii</i>	r/b 16-18cm gt.
Rowan	<i>Sorbus aucuparia</i>	r/b 12-14cm gt.

G1 Amenity Grass (300mm topsoil depth)
Coburn's Low Maintenance seed

G2 Mounded Amenity Grass (300mm topsoil depth)
Coburn's Low Maintenance seed, Grass Mound - max 1m height

B1 - Seasonal Bulbs (300mm topsoil depth)
Bulb planting in grass to be incorporated at 10 bulbs per sq. metre. Mowing to be reduced in accordance with suppliers instructions.

With flowering bulbs, including:
Colchicum autumnale, *Crocus tommasinianus* 'Barrs Purple', *Crocus vernus* 'Jeanne d'Arc', *Crocus sativus*, *Muscari armeniacum*, *Galanthus nivalis*, *Narcissus* 'Jack Snipe', *Muscari armeniacum*, *Narcissus jonquilla*, *Narcissus recurvus*, *Hyacinthoides non-scriptus**

M1 - Wild Flower Meadow
An appropriate dry meadow type with wildflowers for these areas would simulate NVC type MGS. Appropriate herbs for this type of meadow include:
Agrostis capillaris, *anthoxanthum odoratu*, *centaurea nigra*, *cyprusorus cristatus*, *pestuca rubra*, *galium verum*, *leontodon autumnalis*, *leontodon hispidus*, *leucanthemum vulgare*, *lotus corniculatus*, *pimpinella saxifraga*, *plantago lanceolata*, *pra pratensis*, *primula veris*, *trifolium pratense*, *ranunculus acris*, *ranunculus bulbosus*, *rhinanthus minor*, *rumex acetosa**

S1 - Shrub Planting: Public Areas (450mm topsoil depth)

Common Name	Species Name	Specification	Centres
Dogwood	<i>Cornus sanguinea</i> *	c/g 3L 60-90cm ht.	600mm
Autumn Fern	<i>Dryopteris erythrosora</i>	c/g 2L 30-40cm ht.	350mm
Gold-Edged Plantain Lily	<i>Hosta fortunei</i> var. <i>aureomarginata</i>	c/g 2L 20-30cm ht.	350mm
'St. John's wort'	<i>Hypericum perforatum</i> *	c/g 2L 40-60cm ht.	350mm
French Lavender	<i>Lavandula pedunculata</i>	c/g 3L 30-30cm ht.	450mm
Snowy Maermaid	<i>Libertia formosa</i> *	c/g 2L 30-40cm ht.	450mm
Chinese fountain grass	<i>Pennisetum alopecuroides</i>	c/g 2L 40-60cm ht.	450mm

S2 - Residential Edging Buffer (450mm topsoil depth)

Common Name	Species Name	Specification	Centres
Arrowwood	<i>Viburnum x bodnantense</i>	b/r 60-90cm ht.	700mm
Gaulther Rose	<i>Viburnum opulus</i> **	b/r 60-90cm ht.	700mm
Dogwood	<i>Cornus sanguinea</i> *	b/r 60-90cm ht.	700mm
Ribbon Grass	<i>Phalaris fesssey</i>	c/g .5L 20-30cm ht.	400mm
Karl F. Reed Grass	<i>Calamagrostis 'Karl Foerster'</i> *	c/g 2L 30-40cm ht.	700mm
Miscanthus	<i>Miscanthus sinensis 'Gracillimus'</i>	c/g 2L 30-40cm ht.	700mm
Lonicera	<i>Lonicera pileata</i>	c/g 2L 20-30cm ht.	500mm

S3 - Residential Edging Buffer w/ Textured Screening (450mm topsoil depth)

Common Name	Species Name	Specification	Centres
Arrowwood	<i>Viburnum x bodnantense 'Dawn'</i>	b/r 60-90cm ht.	700mm
Gaulther Rose	<i>Viburnum opulus</i> **	b/r 60-90cm ht.	700mm
Dogwood	<i>Cornus sanguinea</i> *	b/r 60-90cm ht.	700mm
Ribbon Grass	<i>Phalaris fesssey</i>	c/g .5L 20-30cm ht.	400mm
Karl F. Reed Grass	<i>Calamagrostis 'Karl Foerster'</i> *	c/g 2L 30-40cm ht.	700mm
Miscanthus	<i>Miscanthus sinensis 'Gracillimus'</i>	c/g 2L 30-40cm ht.	700mm
Lonicera	<i>Lonicera pileata</i>	c/g 2L 20-30cm ht.	500mm
Sinking hellebore	<i>Helleborus foetidus</i> *	c/g 2L 20-30cm ht.	300mm
Dogwood	<i>Cornus alba</i> **	c/g 2L 30-40cm ht.	500mm
Bell heather	<i>Erica cinerea</i> **	c/g 2L 30-40cm ht.	500mm
Alum Root	<i>Heuchera 'Palace Purple'</i>	c/g 2L 20-30cm ht.	300mm
Mugwort	<i>Artemisia vulgaris</i> *	c/g 2L 30-40cm ht.	400mm
Lady Fern	<i>Athyrium filix-femina</i> *	c/g 2L 30-40cm ht.	500mm
Curry plant	<i>Helichrysum italicum</i>	c/g 2L 30-40cm ht.	400mm

S4 - Shrub Planting: Front of Houses (450mm topsoil depth)

Common Name	Species Name	Specification	Centres
Astilbe Japonica hybrid	<i>Astilbe 'Rheinland'</i>	c/g 2L 20-30cm ht.	350mm
St John's wort 'Hidcote'	<i>Hypericum 'Hidcote'</i> *	c/g 3L 30-40cm ht.	600mm
David viburnum	<i>Viburnum davidii</i>	c/g 3L 30-40cm ht.	450mm
English Lavender	<i>Lavandula 'Hidcote'</i> *	c/g 2L 30-40cm ht.	450mm
Dwarf Sweet Box	<i>Sarcococca humilis</i> *	c/g 3L 30-40cm ht.	450mm
Japanese sege	<i>Carex oshimensis 'Evergold'</i>	c/g 3L 30-40cm ht.	450mm
Rosemary	<i>Rosmarinus officinalis 'Roseus'</i> **	c/g 2L 30-40cm ht.	500mm
Lonicera	<i>Lonicera pileata</i>	c/g 2L 20-30cm ht.	500mm

H1 - Structural Hedgerow (450mm topsoil depth)

Common Name	Species Name	Specification	Centres
Ebbing's Silverberry	<i>Elaeagnus x ebbingei</i>	c/g 2L 30-40cm ht.	300mm
Holly	<i>Ilex aquifolium</i> *	c/g 2L 20-40cm ht.	300mm
Green Privet	<i>Ligustrum Ovalifolium</i> *	c/g 2L 40-60cm ht.	300mm

*Species Native to Ireland
**Plants for Pollinators
These plants will provide nectar and pollen for bees and the many other types of pollinating insects.

HARD LANDSCAPE

- Homezone Residential Roadway - Shared Surface - 8085sq.m**
Tarmacadam, hot rolled with red graphic chipping, with in-situ concrete kerbs
- Main Roadway**
Tarmacadam, with in-situ concrete kerbs
- Concrete Footpath**
In-situ concrete. Brushed with trowel edge finish with PC concrete kerbs.
- Homezone Area Footpath - 5100 sq.m (to Engineer's Specification)**
Confall Grouted Macadam or Marshall asphalt, hot rolled with light grey/white graphic chipping.
- Pedestrian Paving - 1798 sq.m (to Engineer's Specification)**
PC granite composite block paving or similar, dim. 200x100x80mm and 100x100x80mm mix, colour to be decided 60:20:20, Staggered bond pattern, or similar, as approved
- Pedestrian Paving Trim - 113 sq.m**
PC granite composite block paving or similar, dim. 200x100x80mm and 100x100x80mm mix, colour to be decided 60:20:20, Staggered bond pattern, or similar, as approved
- Feature Paving (Front of House & Seating Area) - 5896 sq.m**
PC granite composite block paving or similar, dim. 200x100x80mm and 100x100x80mm mix, colour Silver, Blanc, Mid Grey 60:20:20, Staggered bond pattern, or similar, as approved
- Plaza Feature Paving - 422 sq.m**
Tobermore City Pavers, dim. 300x150x100mm, colour Graphite with contrasting tactile pavers. Stretcher bond pattern, or similar, as approved
- Plaza Feature Paving - 434 Sq.m**
Tobermore City Pavers, dim. 300x150x100mm, colour Charcoal with contrasting tactile pavers. Stretcher bond pattern, or similar, as approved
- Compacted Gravel Surface - 939sq.m**
Ballyusk 10mm and down, or similar, as approved
- Own Curtilage Parking - Permeable Surface - 1470 sq.m**
Tobermore Hydropave Pedestel Pavers, dim. 200x100x60mm, colour Heather (Parking Dividers to be Silver, Stretcher bond pattern, or similar, as approved.
- Roadside Parking - Permeable Surface - 1300 sq.m**
Tobermore Hydropave Pedestel Pavers, dim. 200x100x60mm, colour Natural (Parking Dividers to be Charcoal), Stretcher bond pattern, or similar, as approved.
- Cycle Path - 5211 sq.m (to Engineer's Specification)**
Tarmacadam, colour to be decided, or similar, as approved
- Tabled Intersection (to Engineer's Specification)**

LANDSCAPE FURNITURE / FEATURES

- Benches - 50 no.** Final locations to be determined
Hartecast HC2001S Bench or similar, as approved. Length 1950mm, width 540mm, height 450mm, powder coated steel, fixed to the ground by means of anchoring bolts
- Bins - Final locations to be determined**
Hartecast (HC2054) or similar, as approved, colour TDB
- Bollards - Final locations to be determined**
Hartecast (HC2062) brushed metal retractable bollards or similar approved
- Sheltered Cycle Stands - Final locations to be determined**
Sheffield Cycle Stands 1000mm x 1000mm or similar, as approved
- Tree Grills - 3 no.**
1000mm x 1000mm cast iron
- Playground Surfacing - 345 sq.m**
Wetpour Safety Surface
- Found Play Elements**
Natural Play Elements - mounding, stepping stones, balance logs, vertical logs, as agreed prior to taking in charge
- Structured Play Elements**
Multi-age play Elements
- Painted Games**
Thermoplastic painted games on concrete
- Bin Storage - 31 no. locations**
Final locations to be determined
- Concrete Wall**
600mm high in-situ curved concrete wall for seating
- Shared Surface Kerb**
Flush Slipform Concrete Kerb, 300mm height, with expansions joint or similar, as approved
- Boundary Fence (1.2m high)**
Bow-top railing to sides with powder coating, double leaf gates
- Boundary Treatment (1.2m high)**
Timber Post & Rail Fence or Similar Approved
- Feature Wall (2m high)**
Stone or Wet dash with brick finish
- Feature Wall (1.2m high)**
Stone or Wet dash with brick finish
- Residential Boundary Fence (1.8m high)**
Timber panel & concrete post fence or Similar Approved
- Residential Rear Boundary Wall (2m high)**
Concrete block wall with concrete coping

Project Title: Lissyclooney, Athlone

Client: Alanna Roadbridge Developments Dwg No. SHEET

Drawing Title: Landscape Details - Homezone Streetscapes Scale Varies

Job No. 1463 Date 15/02/21

Ronan MacDiarmada + Associates Ltd.
Landscape Architects and Consultants.

5 Tootenhill, Rathcoole, Co. Dublin
tel: +353 1 412 4476 mob: 086 26 25 438
fax: +353 1 401 3748 e-mail: ronan@mda.ie

This Drawing is Copyright ©

REV	DATE	BY	CHECKED	DESCRIPTION
L	15/02/21	PL	RMD	Planning Update
K	18/12/20	PL	RMD	Planning Update
J	23/11/20	PL	RMD	Planning Update
I	03/11/20	PL	RMD	Planning Update
H	21/10/20	PL	RMD	Planning Update
G	25/09/20	PL	RMD	Planning
F	17/09/20	PL	RMD	Planning Draft
E	19/08/20	PL	RMD	Planning Draft
D	23/06/20	MR	RMD	Revised Layout
C	05/02/20	MOT	RMD	Revised Layout
B	30/09/19	MR	RMD	Revised Layout - Engineer Overlay
A	16/09/19	MR	RMD	Revised Layout